

## Rabbit Carrying Straps

These are made from  $\frac{3}{4}$ " Nylon webbing, with a leather shoulder pad, and swivel snap-catches.

Carry up to 20 rabbits

**£7-00**

## Probes

$\frac{1}{2}$ " Stainless or Tensile bar probes.

**£15-00**

## Twisters

Made from Stainless or Tensile bar.

**£7-00**



All Prices plus P&P

# MASTER HUNTER NETS

## PRODUCT CATALOGUE

AUTUMN 2007

[www.masterhunter.co.uk](http://www.masterhunter.co.uk)



Tel: 01980 610366



Email: [masterhunter@btinternet.com](mailto:masterhunter@btinternet.com)  
All major credit cards accepted  
**Ferret Boxes**

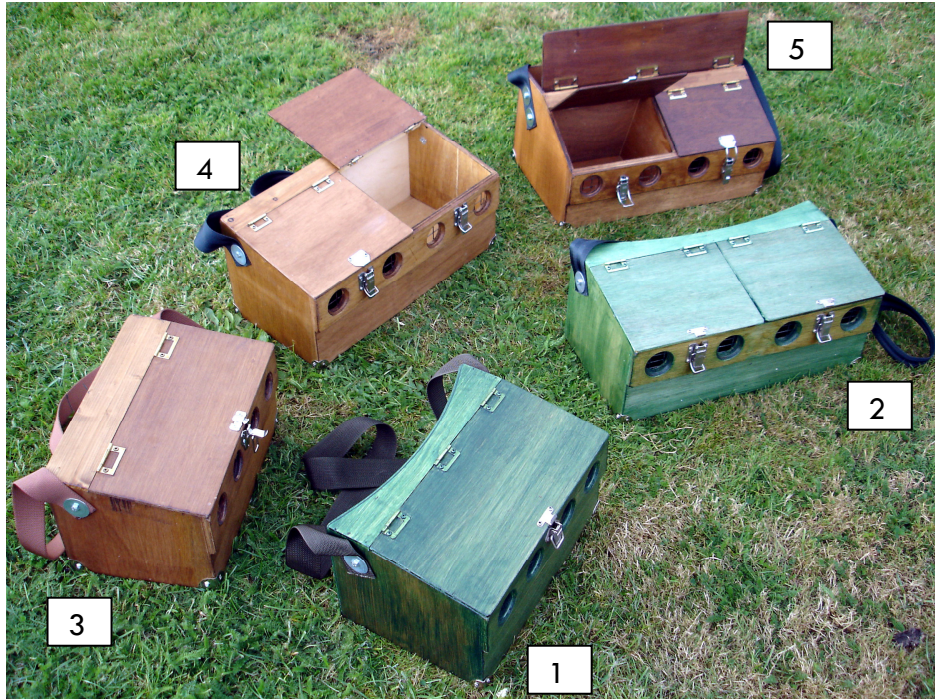

Lightweight ferret boxes made from quality ply. Glued and pinned with camera case catches.

4 corners on all Wiltshire ferret boxes, 2 corners on Norfolk ferret boxes.

50mm nylon webbing carrying strap.

Galvanised mesh on the inside of vent holes.

## Grafts

Lightweight stainless steel grafts are **£25-00**.

Forged steel grafts are **£30.00**.



## Purse nets

Made from 10z nylon.  
4ft long.  
2mm draw cord.

**£2-50 each, £20-00 for 10**



## Fox Nets

Made from 12z nylon.  
6ft long.  
Heavy rings on both ends.  
3mm draw cord.



£8-00 each, £70-00 for 10

Bolt Traps



Ideal for placing in the mouth of rabbit holes where there is too much cover to place purse nets.

Can hold up to 3 rabbits

Made from galvanised 14 gauge 1" Weldmesh

£15-00 each

2 for £25-00

Sizes and Cost

		Width	Depth	Height
		cm(inches)		
1	Single Norfolk £27-00	36(14)	25(10)	20(8)
2	Double Norfolk £35-00	47(18.5)	25(10)	20(8)
3	Single Wiltshire £25-00	36(14)	23(9)	20(8)
4	Double Wiltshire £30-00	47(18.5)	23(9)	20(8)
5	Deluxe Wiltshire £45-00	47(18.5)	28(11)	23(9)

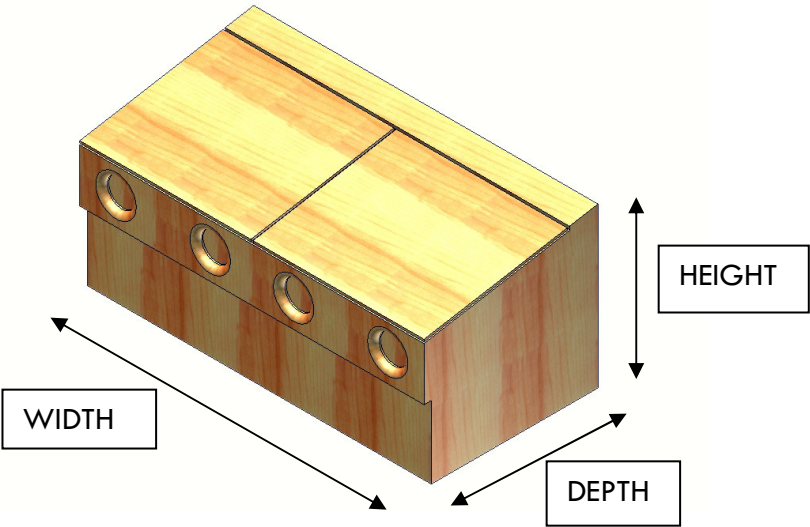



# The Fast Set System

100 yds 6Z Fast Set system weights 7 kilo  
100 yds 4Z Fast Set system weights 6 kilos  
12 poles to 100yd net  
Poles are 40" high, Light weight tensile steel tube, tapering from 5/16 → 5/8 with stainless steel points.  
Powder coated painted with rubber ferrules on top enabling poles to be pushed into the ground easily.  
Bottom line is attached 6" from the bottom of each pole.  
(Can be easily adjusted where necessary)  
When set top line of net is approx 24" from ground, in between any two poles.  
Mesh size is 2 "1/8 knot to knot. Double knotted. Selvedge is doubled.  
The net is 14½ mesh's deep.  
100yd set net is made up with approx 200yds of net, this gives the net 100% of bag / loose mesh, and this enables at least 4 rabbits to be entangled in any one section of net.  
Lines are 2mm braided polypropylene. This allows the net to slide freely.  
Frame is fabricated from 6mm tensile rod then nylon coated.  
Bag is made from waterproof lightweight DPM nylon coated material.  
It takes approximately 2 minutes to set 100 yds of net, and approximately 5 minutes to pick up.  
The net runs freely from the bag, as there are no snagging parts on the frame.  
Poles are superior to fibre glass as they have a constant taper with stainless points, and push into the ground with ease.

We also sell Traditional Long Nets and Sheet Netting.

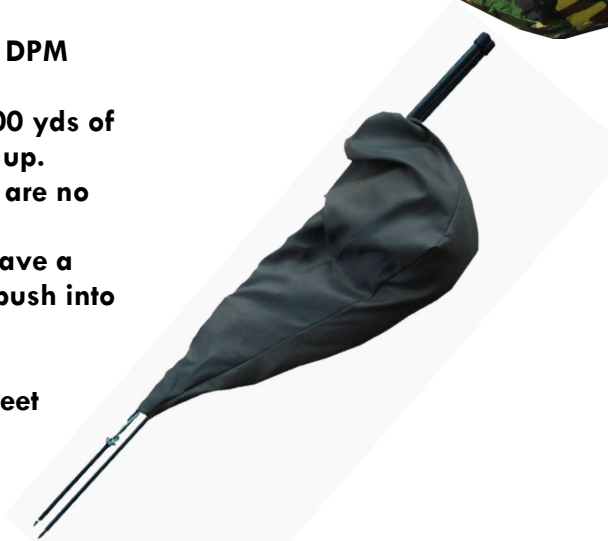

Standard Fast Set	Length / Yards	Diameter / Z	Price / £
	50	4	135.00
	50	6	140.00
	75	4	200.00
	75	6	215.00
	100	4	220.00
	100	6	235.00
Trammel Fast Set	50		175.00
	100		295.00
Standard Stop Net	20	6	45.00
Trammel Stop Net	25	6	65.00